

*artsinfo

The quarterly newsletter for Slough's growing arts community

Inside this issue:

>> Museum launches new book >> 3

>> New resources from Arts Development >> 5

>> Enterprise hub seeking expressions of interest >> 7

Development of arts venue begins

Building work has officially begun on the Space for Sports and Arts venue at Arbour Vale, to transform the school's west wing hall into a community and schools arts and performance space. This exciting development with a seating capacity for 250 people is ideal for theatre, music and dance. This is the first step towards developing the flagship Heart of Slough media and performance space, and gives local people the chance to see, on a smaller scale, the impact and opportunities a local performance space could offer the town.

Once open, the venue will have a professional PA and lighting system, digital projection equipment and blackout facilities for showing film. The space can be easily adapted for rehearsal space, performances in the round, traditional performance layouts, exhibitions, conferences and meetings.

Developing Arbour Vale involves creating a large reception area, a temporary exhibition space, a large meeting area with seating and kitchen facilities, a main auditorium, and improved changing facilities. A full time manager and a technician will be appointed by January 2004 with the aim of having a full programme in autumn 2004.

This is the first dedicated arts space Slough has had for many years and is a key facility for the borough. We look forward to Arbour Vale becoming a long-term success and resource for everyone in Slough.

*For further information about Arbour Vale contact Andy Lee on 01753 875947 or watch this space, *artsinfo will keep you up to date with the development.*

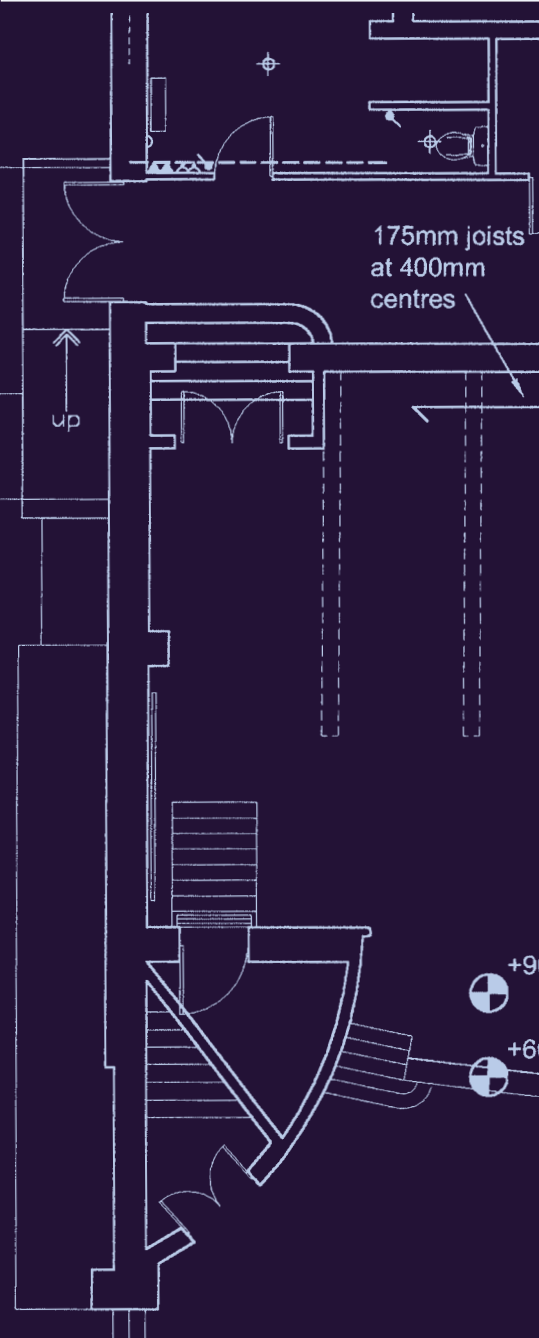

Local Arts

*artsinfo

Editor:
Lara Eldridge
Sub Editor:
Rebecca Cairns

© 2003 SBC all rights reserved

*artsinfo

Arts Development
Slough Borough Council
Town Hall, Bath Road
Slough SL1 3UQ

Tell us your news!

What's happening in your area.
Articles, news stories and
pictures welcome.

Send them to:
artsinfo@slough.gov.uk

*artsinfo NOV 2003 – JAN 2004

Title photo: Section of plan for Arbourvale

*artsinfo is published four times a year and is free of charge. The publication aims to raise the profile of the arts, artists and creative industries in Slough.

To receive a copy regularly, please call: 01753 875667
minicom: 01753 875030
email: artsinfo@slough.gov.uk

Articles and pictures for inclusion in the next *artsinfo must be submitted by
XXXXXXXXXXXXXXXXXXXX.

While every care is taken with submitted material, the editor regrets that no responsibility can be taken for material that is lost or damaged. The views expressed in *artsinfo do not necessarily reflect the official SBC policy. The editor would like to thank everyone who has submitted articles for inclusion in *artsinfo.

www.slough.gov.uk
Slough
Borough Council

Celebrating European Year of Disabled People

2003 is European Year of Disabled People and the UK theme for projects is 'Promoting Rights and Participation'. Arts organisation, ITHACA, is co-ordinating a combined arts programme in Slough and the surrounding area to celebrate and showcase the creative achievements of people with disabilities.

In Slough, members of The Neo Phoenix Centre in Langley worked with ceramicist Aline Stanway and musician/storyteller Jackie Singer for twelve weeks. Participants chose to take the myth of the phoenix rising from the ashes as a starting point to



>> Stained glass, recent ITHACA project

explore their own personal journeys. The project included people with a range of disabilities including visual impairment, physical disability, mental health needs and dementia.

Work from this programme will be exhibited at South Hill Park Arts Centre in Bracknell from 2 Dec 2003 - 2 Feb 2004.

Indian Performing Arts workshops

Yuwati Society's workshops are taking place at Langley Community Hall, every Monday: Keyboard and Tabla from 5.00-7.00pm and every Wednesday: Yoga from 6.00-7.00pm and Textile Design from 6.30-8.30pm.

For further details call 07956 151498 (daytime) or 01753 671964 (evening)

PAPERCHAIN©

Asham Kamboj of Paperknife Productions, Amit Kamboj of Innov-8 Music Studio and Dominique Oliver of Resource Productions began piloting a three week intensive professional film and music production course, Innov-8, this summer in conjunction with Thames Valley University and supported by Learning & Skills Council Berkshire and Slough Borough Council.

Innov-8 is a team of 20 filmmakers and musicians age 16+ living in and around Slough. Collectively, they brainstormed a short script entitled PAPERCHAIN, produced the soundtrack, shot and edited the film and created publicity material all aided by a team of film, music and design professionals. The film will be screened on 25 November, UGC Cinema, Slough.

For further information contact Innov-8 at paperchain_8@yahoo.co.uk

Conflict resolution video tool pack launched

Aik Saath is a peer education project working with young people and providing training in conflict resolution skills to a variety of agencies. As part of this training, young people alongside professionals have produced a video, to be used by young people and practitioners to help develop effective conflict resolution skills.

For more information contact Aik Saath on 01753 574780.

New book about Slough's history...

Slough Museum, working in partnership with local groups, individuals and other organisations have researched and written a new book, 'The Changing Face of Slough' looking at the last 100 years of the Borough of Slough's history. It is a detailed, highly illustrated account of the recent history of the wards that make up the borough of Slough. The book is illustrated with over 300 photographs drawn mainly from the archive at Slough Museum.

'The Changing Face of Slough' provides a record of the people, places and events that have made Slough what it is today. The story has been made possible by extensive research undertaken by local people and information derived from the archives held by the Slough Museum.

The book is published by Breedon Books, priced at £14.99.

For further information contact Joanna Follett, Curator at Slough Museum, 278/286 High Street, Slough, SL1 1NB, on 01753 526422 or email info@slough-museum.co.uk

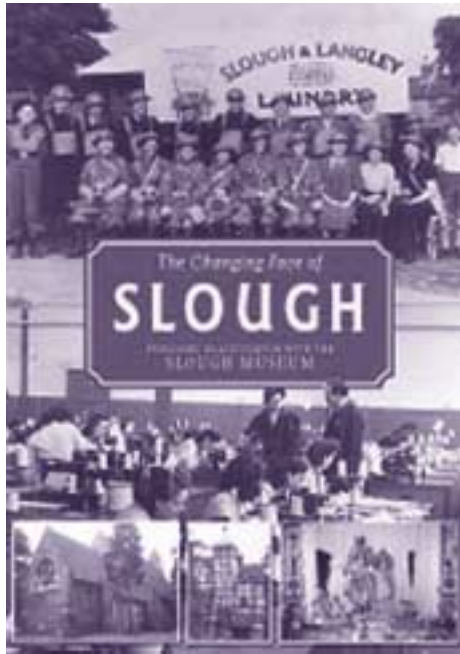

>> *The Changing Face of Slough*

Local focus

SMTC prepare for their next musical

Following Slough Musical Theatre Company's vibrant production of Jesus Christ Superstar this summer, SMTC are already rehearsing for their next musical Little Shop of Horrors which will be performed at Norden Farm Centre for the Arts, Maidenhead from 3 - 7 Feb 2004. Rehearsals are taking place at Haymill Community Centre every Monday & Wednesday evening at 7.45pm.

Ticket prices are £10.00 with concessions at £9.00 each. If you order and pay for your tickets before 1 Jan 2004 all seats will be priced at £8.50.

To order tickets contact the Norden Farm Box Office on 01628 788997.

Thames Valley Music Festival 2004

After a successful first year the Thames Valley Music Festival is pleased to announce a second syllabus and the exciting addition of classes for Asian Classical Music, which include tabla, sitar, flute, veena, violin and other solo instruments. These classes will be adjudicated by Punita Gupta who has learnt vocal and sitar and has been taught by the world famous Ravi Shankar for the past 27 years.

For a syllabus or further information contact June Henson on 01753 642619.

Teachers Preview Club

The Mousetrap Foundation is a theatre education charity, dedicated to providing access and education opportunities for young people. One of eleven programmes that we run is the Teachers Preview Club. This is an independent theatre club open to all teaching professionals throughout the UK and aims to make theatre more affordable. Annual subscription is only £20 and entitles members to purchase two reduced price theatre tickets to over a hundred productions a year with ticket prices from as little as £5 to £15. A newsletter is out this month highlighting the offers currently available.

To find out more contact Naomi Thomas, Programmes Administrator on 020 7240 1248 or visit www.mousetrap.org.uk.

Join the Slough Arts Development marketing list

Under the Data Protection Act 1998 we are required to gain your "informed consent" to add your name and details on to our marketing list.

*We would like you to join this list so that we can send you **★artsinfo** and information about funding programmes/events/performances/workshops and training organised by Slough Arts Development, other Slough Borough Council departments, other local or regional community/arts/education organisations we think are relevant.*

We will also use the information we will hold to assist towards statistics used to promote the Arts.

Arts & Business is a charitable organisation that is the world leader in developing creative relationships between business and the arts. They have an extensive range of programmes and services to help skill up artists and arts managers to access sponsorship and use their creative talents to inspire business.

How can Arts & Business help?

Arts & Business runs Sponsorship Seminars, which are aimed at those new to sponsorship and concentrates on making approaches to business. The seminar examines why businesses sponsor the arts, how to manage a sponsorship relationship and covers others such as employee volunteering and art in the workplace. Arts & Business also offer the opportunity to join the Development Forum, a network of like-minded arts and heritage

professionals working across the South East in development and fundraising roles.

As well as offering sponsorship and development advice in One to One Surgeries, Arts & Business also has money to invest in business and arts relationships through the Double Your Money and New Partners schemes.

Show me the money

Double Your Money is for first time business sponsors of the arts and the smaller budget. The Double Your Money programme aims to stimulate small and medium size businesses to engage in arts partnerships for the first time and to 'road-test' arts sponsorship on a small scale before committing to greater investments. Large companies, that are first time sponsors of the arts, may also apply. The Double Your Money scheme will match a business sponsorship investment in the arts pound for pound up to £1,000.

The New Partners investment pro-

gramme aims to build on Double Your Money and encourages a relationship that goes beyond 'traditional' sponsorship by giving the business a risk free opportunity to try something new with the arts. Investments can be applied for between £1,000 and £50,000.

Money can't buy...

Arts & Business can offer you business expertise at no cost to aid your professional and organisational development through their Skills Bank and Board Bank programmes. If you have a specific management project you need help with, or you are currently trying to recruit a board member from the business sector, Arts & Business could help you. Arts & Business also offers an Introduction to Board Membership seminar aimed at helping new Board Members.

To find out more about Arts & Business contact Jeannie Blumire on 023 8061 9172 or email Jeannie.Blumire@AandB.org.uk

✓ Pearshape at Debenhams restaurant, Guildford

Marketing List - Entry form

Please complete in CAPITAL letters

First Name

Surname

Position (If applicable)

Organisation (If applicable)

Address

Postcode

Tel No

Fax No

Email

Website

- Professional Artist Voluntary Artist
- Professional Arts Org Voluntary Arts Org

How would you like to receive information from us:

- Post email

Please tick the box if you would like us to share your details with other relevant organisations as detailed overleaf.

Please return the marketing card to: **Arts Development, Slough Borough Council, FREEPOST (SCE 8944), SLOUGH, SL1 3BR**



Phil Griffith

Arts Development, Slough Borough Council are introducing new resources as part of their service. The new design of ***artsinfo** newsletter is just one of the changes to our resources. Developing from the newsletter will be a website for Slough's creative community, giving more people more access to our services and artists as well promoting all the creative work happening here in Slough.

Community Arts Training in Slough continues to be in huge demand. Following on from this we have set up a series of funding seminars. These seminars aim to encourage a closer relationship between funding bodies, local people and ourselves, so that we can all work together to increase the amount of funding coming into Slough, enabling all the creative projects being developed around the borough to happen.

CATS - 10 year's old

Community Arts Training in Slough (CATS), is a practical training course aiming to equip participants with the skills needed to set up and run arts projects in the community. The course takes place at the Learning Resources Centre, Thames Valley University, Slough on 5-6 & 12-13 March 2004, 9.30-4.30pm. Booking required.

Organised by Arts Development, Slough Borough Council in partnership with artist Christine Wilkinson. CATS is a free 4-day course, for people living or working in Slough. It offers the knowledge and skills of expert trainers and has attracted regional and national interest.

For further information contact Arts Development on 01753 875667.

*artsinfo - new website promoting creativity in Slough

December will see the launch of the website for the arts in Slough, a new resource for Slough's artists, arts organisations, schools and voluntary groups. Offering advice, support and information on creativity we hope it will become invaluable to any one interested in the arts. So whether you are looking for a creative professional to work with, seeking arts funding or are an artist offering courses and workshops, the website will provide a wealth of information on all that is possible. From practicalities to inspiration!

The site will include an archive of ***artsinfo** newsletters, case studies of inspirational local arts projects and a directory of artists, which will link practitioners with project opportunities and is a direct route for local

groups to find an arts practitioner to work with on projects.

For further information contact 01753 875667/875576.



>> The homepage of ***artsinfo**

Unlocking Funding 2003/2004

Arts Development are pleased to introduce a new series of FREE one-hour fundraising seminars run by Arts Development, Slough Borough Council in partnership with national funding organisations. This series is available to arts organisations, individuals and community groups working with the arts and who are based in Slough.

Each seminar will include a presentation from the funding organisation. This will be followed by a session for questions and answers. All seminars

will take place 5.30-6.30pm at Slough Tennis Centre, Salt Hill Park. There is plenty of free parking and tea and coffee will be provided.

There will also be the opportunity to book a one-to-one surgery with a representative from the funding organisation that will take place a month after each of the seminars. You will need to attend the seminar to book one of these sessions.

Places are limited so book early.

Seminar topics

- Mon 17 Nov** - Arts & Business
- Mon 24 Nov** - Local Network Fund
- Mon 8 Dec** - Youth Music
- Mon 12 Jan** - Arts Council England
- Mon 9 Feb** - Heritage Lottery Funding

Please find the leaflet and booking form in this edition of artsinfo, if you would like one and cannot find it in this edition please contact Arts Development on 01753 875667.

Latest News

Slough Pow Wow

On 26 September 2003, over one hundred people gathered at Vikram's Occasions Palace for Slough Creative Partnerships first 'Slough Pow Wow'. This event aimed to promote dialogue between local creative practitioners and Slough Creative Partnerships teachers. There were lots of opportunities to talk, but also more structured sessions around the local creative picture, being creative in partnership and the practicalities around planning. The feedback showed the event to be a success with participants asking - please can we do it again?!

For more information contact Anna on 01753 470324 or anna.jones@creative-partnerships.com

Local company seek local stars

RIFCO are a Slough based Production Company who produce theatre and film. RIFCO are producing a new theatre production for 2004, which will be relevant and accessible to all people living in Slough. They are looking for your involvement in their next script development process, which involves research and an intensive workshop. They are looking for music directors, a white/mixed race actress, British Asian actors, ladies sangeet/folk singers, community performers and South Asian musicians.

Please post CVs, photographs, tapes and any additional material to RIFCO, 17 Brighton Spur, Slough, SL2 1UP or email info@therifco.org. Please note

photos and CVs are essential for the acting parts.

Youth Festival a real hit!

Crowds of over 2500 filled Upton Court Park on Sunday 31 August for a day of information, performance and cultural fusion aimed at young people across the borough. The main stage boasted a wide selection of acts, while the chill-out marquee gave visitors the chance to soak up the atmosphere. Prizes were presented to two local groups who won time in a BBC studio with a producer or singer/songwriter. People can be certain that the Youth Festival will be back bigger and better in 2004.

For further information contact Daren on 01753 875021.

Training

New vocal training

Children aged 8-15 can participate in an eight-week vocal training scheme organised by new group Alpha Centre Community Outreach (ACCO), 40-41 Herschel Street.

For further information contact Marva Daure on 01753 523746 or Dele Williams on 01753 551956

Creative Horizons

Slough Borough Council, Thames Valley University and Creative Partnerships are bringing a week of creative events to Slough. Creative Horizons will celebrate the town's creative talent and activities.

As well as building on the success of last year's Creative Careers Showcase, 11-12 Nov, there will be a 'Creative Fair' on Tues 11 Nov 4.30 -

7.00pm at Thames Valley University. This will bring together all training providers in the area to give advice to all those looking to enter or develop a career in the creative sector.

Contact Alison Hibbert on 01753 875896 for further details.

SCVS Training

Slough Council for Voluntary Services are offering their new training programme for voluntary and community groups from Oct 2003 - Mar 2004. For a full brochure contact training@sloughcvs.org.uk, here are a few highlights:

4 Nov Event Management
17 Feb Looking after money
24 Feb Financial project planning
22 Apr Application Management
6 May Legal Responsibilities

If you do not see the training that you require then call Dieu Donne Hak-Palay on 01753 875562 or Rochana Sheward on 01753 524176.

Creative Academy Workshops

Creative Academy are running a series of workshops for people interested in or working in a creative field, organised by the Heart of Slough. The sessions take place from 10.00am-4.00pm at Thames Valley University, Slough. Ages 16 and over. Places are limited so book early by calling George on 01753 875949.

11 Nov Creative Inspiration
13 Nov How to make friends and influence people
17 Nov Make your first Million
17 Nov Creating a Business Plan

Via Dolorosa in Slough

Volunteers at Young Performers at Saint Mary's, Slough's arts platform are preparing busily for an exciting workshop that will bridge faith and the arts. The arts platform has, in the past, worked closely with local people, with the aim to encourage them to engage creatively in the creative arts. Now they seek to reach out to artists of all disciplines from Slough's faith communities.

Based on the historic Via Dolorosa, the workshop will centre on the creation of a multi-media art installation of fifteen stations. Each station will consist of its own monitor and will reflect a point on the Via Dolorosa in the Old City of Jerusalem. While Christians know the Via Dolorosa as the 'Stations of the Cross', the workshop seeks to present this traditionally Christian story as seen through the eyes of local community groups. At the heart of the workshop is the idea that faith-communities in Slough will work together in bringing to life this story of human suffering, so that artists from different communities share in the production of this unique installation.

Young Performers Vice-Chairman David Sparrow told **★artsinfo**: 'For the realisation of Via Dolorosa we expect to draw on a wide range of performing and creative arts, such as dance, drama, painting or poetry. We are taking a traditional Christian event and 'giving it away'. This is a high risk venture. We have to be brave enough to say to artists of other faiths "What do you make of this?" Then we have to be receptive enough to listen to the answer in the form of the presented multi media presentation" It is a very challenging prospect. We'd aim first of all to present two pilot multi-media stations in time for Holy Week 2004, and then to work with local artists on the remaining stations next summer. Once they are completed, they'd be featured in St Mary's Church's Holy Week celebrations, in 2005 but we would be thrilled if the installation could tour locally after the launch'.

Interested artists and potential exhibitors can contact David Sparrow on Tel. 01753 832233 or e-mail him on davidjsparrow@ntlworld.com. For information on the historic Via Dolorosa visit http://www.holylandnetwork.com/jerusalem/via_dolorosa/via_dolorosa.htm

Opportunities for creative industry enterprises

A New Media Enterprise Hub has been created through partnerships and funding between Slough Borough Council and Thames Valley University with significant investment from SEEDA (The South East England Development Agency). The hub has been developed from the support Slough Borough Council has given creative industries over the past few years.

The Enterprise Hub will be a cluster of new media enterprises from sole traders up to SME's and will offer desk space with computers and telephones, meeting rooms, advice and guidance and a professional frontage for your enterprise. The lease can last for up to three years with subsidised rental costs, encouraging smaller enterprises to become established over time.

A Director has been appointed and is due to start in November. The hub will be based at the Paul Hamlyn Learning Resource Centre with the aim of relocating to the Heart of Slough creative hub, once it has been built.

For further information contact Sue Roberts on 01753 697616.



New ventures in Cinema

Slough Co-operative Film Society has just secured an agreement with UGC Cinemas to screen a programme of films in their Slough Cinema from Jan-May 2004. The Society will continue with its policy of showing quality films from around the world.

Membership of the Society allows members to see all films for free, attend special events and receive a newsletter. The Society is keen to encourage new members.

The Society is planning screenings of The Lord of the Rings: part 1 & 2 prior to the release of Lord of the Rings: The Return of the King at the UGC cinema on 18 Jan 2004. The screenings will take place in the atmospheric Gothic surroundings of St Mary's Church, Slough on Fri 5 and 12 and Sat 6 and 13 Dec 2003.

For more information contact 01784 434868.

Why not take part?

Slough Arts Festival's planning is well underway, with the 2004 syllabus for all sections of the festival available from Nov 2003.

This year's syllabus includes fine arts and handicrafts, music, highland, scottish, classical and modern stage dance, photography and creative writing.

For dates and venues for the different sections or your copy of the 2004 syllabus contact The General Secretary, Slough Arts Festival, The Lodge, Lascelles Park, Lascelles Road, Slough or call 01753 520685.

What's happening?

| Date | Time | Event | Venue | Contact |
|---------------------------|----------------------|--|--|-----------------------|
| November | | | | |
| 3 | 7.30-9.30pm | Slough Writers Group - ARTICLE COMP Results & reading, Judge: Ted Jones | The Greyhound Skittle Alley, Eton Wick | 01628 661725 |
| 3 | 8.00pm | Slough Creative's Meeting | 'Que Pasa', High Street | dom.oliver@virgin.net |
| 10 | 7.30-9.30pm | Slough Writers Group - | The Greyhound Skittle Alley, Eton Wick | 01628 661725 |
| 10 | 4pm-4.45pm | Storytime with children's author Antony Lishak | Slough Library | 01753 535166 |
| 10-14 | | Creative Horizons | Borough wide | 01753 875896 |
| 17 | 7.30-9.30pm | Slough Writers Group - DISCUSSION NIGHT: tba | The Greyhound Skittle Alley, Eton Wick | 01628 661725 |
| 17 | 5.30-6.30pm | Unlocking Funding - Arts & Business seminar | The Tennis Centre | 01753 875667 |
| 22 | 2.00-3.00pm | Panjabi Storytime with Paramjit Kaur | Slough Library | 01753 535166 |
| 24 | 7.30-9.30pm | Slough Writers Group - CRAFT: tba | The Greyhound Skittle Alley, Eton Wick | 01628 661725 |
| 24 | 5.30-6.30pm | Unlocking Funding - Local Network Fund seminar | The Tennis Centre | 01753 875667 |
| 25 | | Screening of Paperchain | UGC Cinema, Slough | dom.oliver@virgin.net |
| 4 -29 Nov | Museum opening hours | The 'Slough Art Society' annual exhibition, displaying work by local artists available for purchase. | Slough Museum | 01753 526422 |
| December | | | | |
| 1 | 8.00pm | Slough Creative's Meeting | 'Que Pasa', High Street | dom.oliver@virgin.net |
| 1 | 7.30-9.30pm | Slough Writers Group - SUMMER COMP: Results, read Crime Abroad: 4-5,000 word story, self-judged | The Greyhound Skittle Alley, Eton Wick | 01628 661725 |
| 2 Dec 2003 - 2 Feb 2004 | | ITHACA exhibition Celebrating European Year of Disabled People, 2003 | South Hill Park Arts Centre | Alison@ithaca.org.uk |
| 5 | | Lord of the Rings part 1 & 2 | St Mary's Church | 01784 434868 |
| 6 | | Lord of the Rings part 1 & 2 | St Mary's Church | 01784 434868 |
| 8 | 7.30-9.30pm | Slough Writers Group - CHRISTMAS DINNER-DISCO | The Greyhound Skittle Alley, Eton Wick | 01628 661725 |
| 8 | 5.30-6.30pm | Unlocking Funding - Youth Music seminar | The Tennis Centre | 01753 875667 |
| 10 Dec 2003 - 28 Feb 2004 | Museum opening hours | 'Making History', an exhibition charting a cross-generational community history project. | Slough Museum | 01753 526422 |
| 12 | | Lord of the Rings part 1 & 2 | St Mary's Church | 01784 434868 |
| 13 | | Lord of the Rings part 1 & 2 | St Mary's Church | 01784 434868 |
| 20 | | Deadline for Thames Valley Music Festival entries | | 01753 642619 |
| January | | | | |
| 5 | 7.30-9.30pm | Slough Writers Group - Start of Spring Session 2004 | The Greyhound Skittle Alley, Eton Wick | 01628 661725 |
| 12 | 5.30-6.30pm | Unlocking Funding - Arts Council England seminar | The Tennis Centre | 01753 875667 |

Arts Development - supporting creativity in Slough

Arts Development, Slough Borough Council, works in partnership with local people to provide the following services for arts organisations, community groups, artists, living or working in Slough and local residents

- >> Advice and support which extends to any creative related enquiry, if we can't help we will find someone who can.
- >> Resources which include our quarterly **★artsinfo** newsletter and our new **★artsinfo** website available in the New Year.

>> Training which includes CATS, a regionally and nationally recognised course about how to set up and run arts projects in the community and Unlocking Funding, a series of one-hour funding seminars designed to explain funding available for arts projects.

>> Publications which include Art & People, a practical guide to running arts projects in the community written by Arts Development and artist Christine Wilkinson. Available from Slough Library 01753 522 869 £10 plus p&p

>> Directory of Artists which links arts practitioners with opportunities and is the direct route for local groups to find an arts practitioner to work with on projects, soon to go online on the **★artsinfo** website.

>> Public Art Programme we are committed to providing high quality public art with community consultation and participation at its core and have experience of managing public art commissions.